



GripLoc™ Compression Adapters



GripLoc™ Compression Male Adapters

GripLoc™ Compression Female Adapters

GripLoc™ Compression Male Adapter

WARNING: DO NOT INSERT FINGERS
 Mipt x EPDM GripLoc™ Gasket
 For Cold Water Only
Hand Tighten ONLY - No Nut Wrenches Required

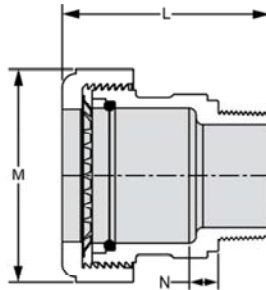

Part Number	Size	L	M	N	Approx. Wt. (Lbs.)
S135-05	1/2	2-9/16	1-13/16	1/4	.12
S135-07	3/4	2-13/16	2-1/8	5/16	.18
S135-10	1	3-1/8	2-1/2	5/16	.25
S135-12	1-1/4	3-3/8	2-15/16	11/32	.35
S135-15	1-1/2	3-9/16	3-5/16	3/8	.47
S135-20	2	3-7/8	3-7/8	13/32	.72

GripLoc™ Compression Female Adapter

WARNING: DO NOT INSERT FINGERS
 Fipt x EPDM GripLoc™ Gasket
 For Cold Water Only
Hand Tighten ONLY - No Nut Wrenches Required

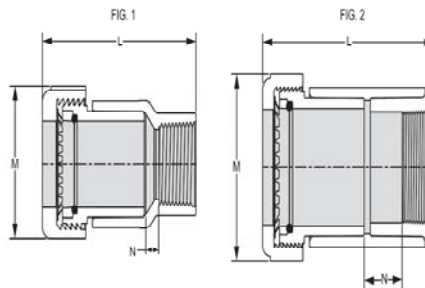

Part Number	Size	L	M	N	FIG.	Approx. Wt. (Lbs.)
S136-05	1/2	2-13/16	1-13/16	3/32	1	.15
S136-07	3/4	3-3/16	2-1/8	3/16	1	.23
S136-10	1	3-5/8	2-1/2	7/32	1	.35
S136-12	1-1/4	4-1/8	2-15/16	9/16	2	.50
S136-15	1-1/2	4-1/2	3-5/16	9/32	2	.81
S136-20	2	5-7/16	3-7/8	1-1/32	2	1.32



GripLoc™ Compression Fittings Installation

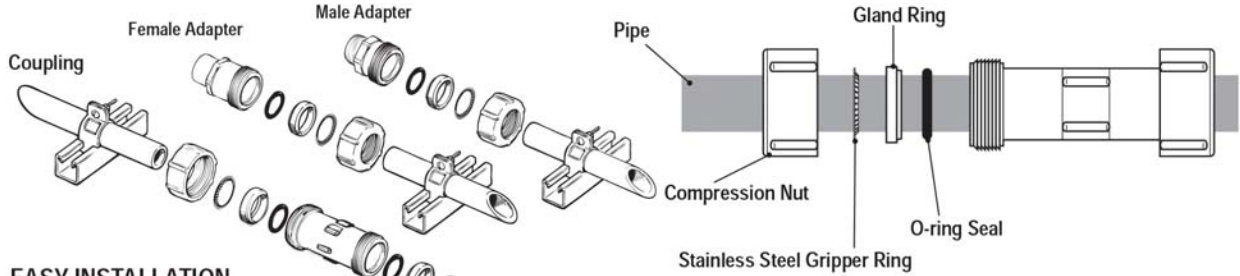

EASY INSTALLATION

Spears® GripLoc™ Compression Couplings easily install by simply sliding nut over pipe, slip on components in order shown, then insert into body and tighten nuts.

STEP 1

Install Compression Nut.

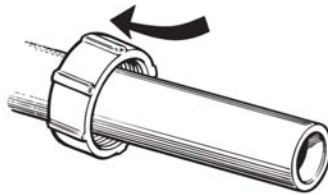

STEP 2

Install Gripper Ring.

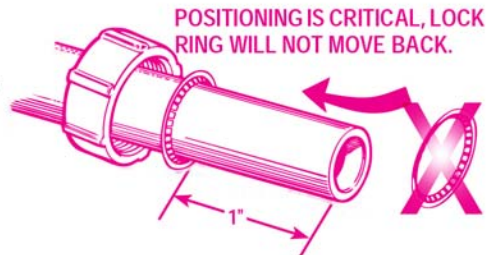

STEP 3

Install Gland Ring and pre-lubricated O-ring.

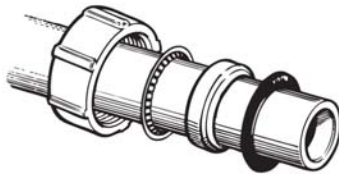

STEP 4

Slide Gripper Ring, Gland Ring & O-ring down until O-ring is 1" from pipe end.

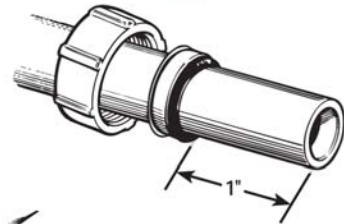

STEP 5

Gripper ring, gland ring, O-ring and body must be mated together before tightening nut. Use equal pressure to bottom out the Gland Ring to body.

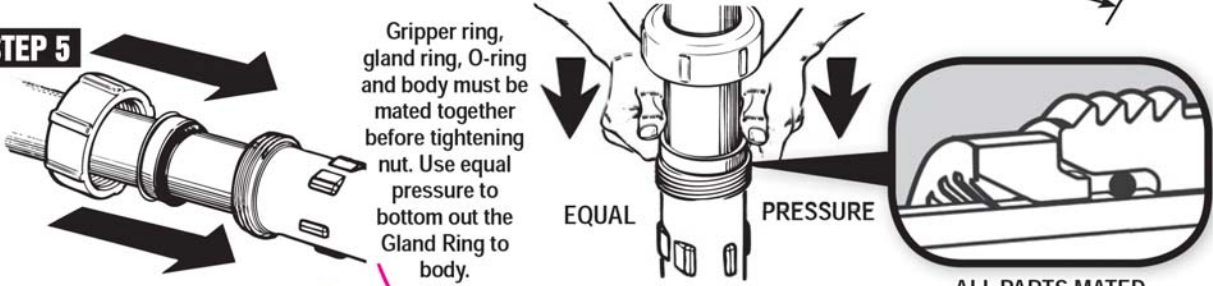

STEP 6

Hand Tighten only Compression Nut. DO NOT use Compression Coupling Nut Wrench or Strap Wrench. Additional tightening is not required to seal.

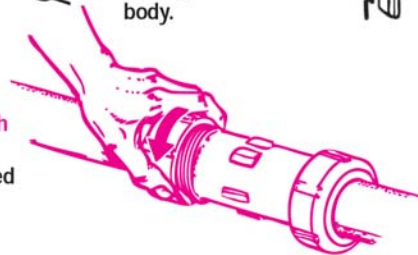

WARNING: DO NOT INSERT FINGERS. ENSURE THAT PIPE AND FITTINGS ARE FREE OF DIRT AND DEBRIS PRIOR TO INSTALLATION.

CONVERT FITTINGS TO COMPRESSION OUTLET

Socket-type fittings 3/4" through 2-1/2" can be easily converted to GripLoc™ compression outlet sizes 1/2" through 2" by simply cutting the Griploc™ Compression Coupling at the center holding ribs and solvent welding the spigot body into a fitting socket.



Compression Coupling Size (in.)	Body Spigot Size (in.)
1/2	3/4
3/4	1
1	1-1/4
1-1/4	1-1/2
1-1/2	2
2	2-1/2