



Polypropylene Schedule 80 Natural & Black SR Threaded Fittings



ENGINEERING GUIDE

Contact Spears® for any Information not found.

Polypropylene Technical
Polypropylene Schedule 80 Natural SR Threaded Fittings



Tee - Natural

SR Fipt x SR Fipt x SR Fipt

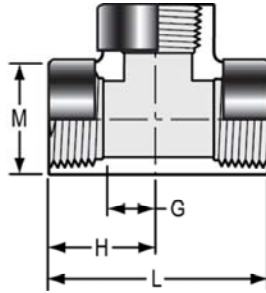

Part Number	Size	G	H	L	M	Approx. Wt. (Lbs.)
4805-005SR	1/2	19/32	1- 9/32	2-17/32	1- 7/32	.09
4805-007SR	3/4	21/32	1- 5/16	2-21/32	1- 3/8	.11
4805-010SR	1	27/32	1-25/32	3- 3/4	1-11/16	.26
4805-015SR	1-1/2	1- 3/16	2- 1/8	4- 1/4	2- 7/16	.41
4805-020SR	2	1-19/32	2-19/32	5- 3/16	3	.75

90° EII - Natural

SR Fipt x SR Fipt

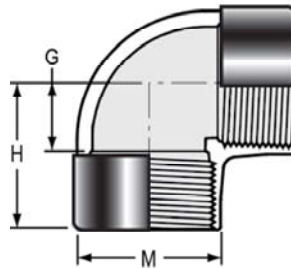

Part Number	Size	G	H	M	Approx. Wt. (Lbs.)
4808-005SR	1/2	9/16	1- 1/4	1- 7/32	.07
4808-007SR	3/4	9/16	1- 5/16	1- 3/8	.07
4808-010SR	1	13/16	1-23/32	1-23/32	.16
4808-015SR	1-1/2	1- 3/32	2- 3/32	2- 7/16	.31
4808-020SR	2	1-13/32	2-13/32	3	.48

45° EII - Natural

SR Fipt x SR Fipt

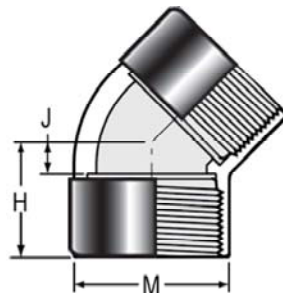

Part Number	Size	H	J	M	Approx. Wt. (Lbs.)
4819-005SR	1/2	31/32	1/4	1- 7/32	.05
4819-007SR	3/4	1- 1/16	5/16	1- 3/8	.07
4819-010SR	1	1- 7/32	5/16	1-23/32	.11
4819-015SR	1-1/2	1- 3/8	3/8	2-13/32	.23
4819-020SR	2	1- 5/8	1/2	3- 1/32	.39



Polypropylene Technical
Polypropylene Schedule 80 Natural SR Threaded Fittings

Coupling - Natural

SR Fipt x SR Fipt

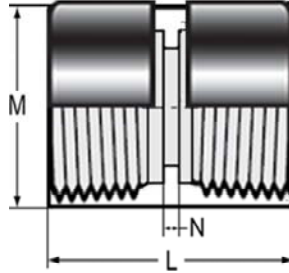

Part Number	Size	L	M	N	Approx. Wt. (Lbs.)
4830-005SR	1/2	1-19/32	1- 3/16	3/32	.04
4830-007SR	3/4	1-19/32	1- 3/8	7/32	.05
4830-010SR	1	2- 1/32	1-23/32	7/32	.09
4830-015SR	1-1/2	2	2- 7/16	1/8	.17
4830-020SR	2	2- 3/32	3	3/32	.26

T.T. Bushing - Natural

Mipt x Fipt

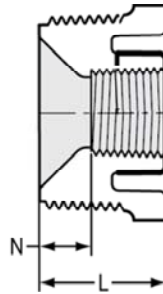

Part Number	Size	L	N	Approx. Wt. (Lbs.)
4839-101	3/4X1/2	15/16	1/4	.01
4839-130	1X1/2	1- 1/8	7/16	.03
4839-131	1X3/4	1- 1/8	7/16	.02
4839-211	1-1/2X1	1- 7/32	7/16	.05
4839-249	2X1	1- 5/16	7/16	.10
4839-251	2X1-1/2	1- 5/16	3/8	.07

Cap - Natural

SR Fipt

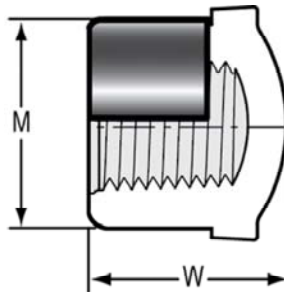

Part Number	Size	M	W	Approx. Wt. (Lbs.)
4848-005SR	1/2	1- 7/32	1- 3/32	.03
4848-007SR	3/4	1- 3/8	1- 3/32	.04
4848-010SR	1	1-23/32	1- 3/8	.06
4848-015SR	1-1/2	2- 7/16	1-17/32	.14
4848-020SR	2	3- 1/32	1- 5/8	.21

Polypropylene Technical
Polypropylene Schedule 80 Natural SR Threaded Fittings



Union - Natural

SR Fipt x SR Fipt with FKM O-ring

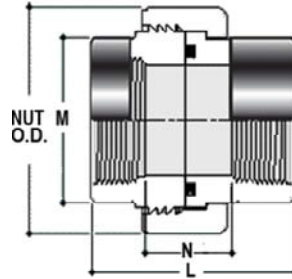

Part Number	Size	L	M	N	NUT O.D.	Approx. Wt. (Lbs.)
4858-005SR	1/2	1-15/16	1-3/16	15/16	2-1/32	.09
4858-007SR	3/4	2-5/32	1-3/8	21/32	2-9/32	.13
4858-010SR	1	2-9/16	1-11/16	13/16	2-9/16	.20
4858-015SR	1-1/2	2-27/32	2-13/32	29/32	3-17/32	.39
4858-020SR	2	3-7/32	3-1/32	1-3/16	4-7/32	.62

Union - Natural

SR Fipt x SR Fipt with EPDM O-ring

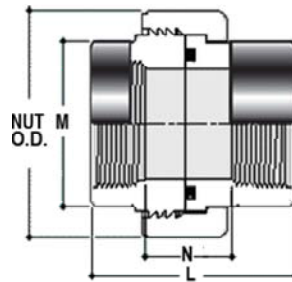

Part Number	Size	L	M	N	NUT O.D.	Approx. Wt. (Lbs.)
4898-005SR	1/2	1-15/16	1-3/16	15/16	2-1/32	.09
4898-007SR	3/4	2-5/32	1-3/8	21/32	2-9/32	.13
4898-010SR	1	2-9/16	1-11/16	13/16	2-9/16	.20
4898-015SR	1-1/2	2-27/32	2-13/32	29/32	3-17/32	.38
4898-020SR	2	3-17/32	3-1/32	1-3/16	4-7/32	.62

Flange - Natural

SR Fipt

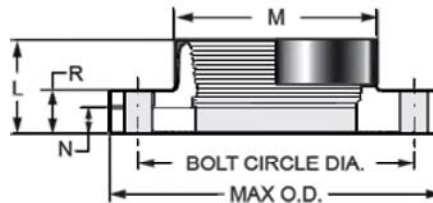

Part Number	Size	L	M	N	R	Bolt Circle Dia.	Bolt Size	Max. O.D.	No of Bolts	Approx. Wt. (Lbs.)
4852-005SR	1/2	1-3/32	1-7/32	13/32	1/2	2-3/8	1/2	3-15/32	4	.12
4852-007SR	3/4	1-3/16	1-3/8	9/32	9/16	2-3/4	1/2	3-27/32	4	.18
4852-010SR	1	1-7/16	1-23/32	7/32	5/8	3-1/8	1/2	4-3/16	4	.25



Polypropylene Technical
Polypropylene Schedule 80 Natural SR Threaded Fittings & Polypropylene Schedule 80 Black SR Threaded Fittings

Flange - Natural

(Continued)

SR Fipt

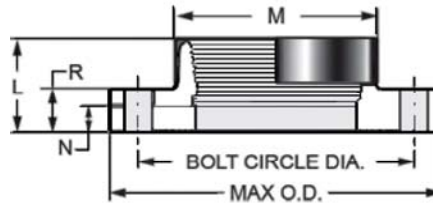

Part Number	Size	L	M	N	R	Bolt Circle Dia.	Bolt Size	Max. O.D.	No of Bolts	Approx. Wt. (Lbs.)
4852-015SR	1-1/2	1-11/16	2- 7/16	15/32	23/32	3- 7/8	1/2	4-15/32	4	.39
4852-020SR	2	1-27/32	3	27/32	27/32	4- 3/4	5/8	5-29/32	4	.61

Blind Flange - Natural

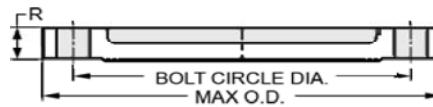

Part Number	Size	R	Bolt Circle Dia.	Bolt Size	Max. O.D.	No of Bolts	Approx. Wt. (Lbs.)
4853-005	1/2	1/2	2- 3/8	1/2	3-13/32	4	.13
4853-007	3/4	9/16	2- 3/4	1/2	3-27/32	4	.18
4853-010	1	5/8	3- 1/8	1/2	4- 3/16	4	.25
4853-015	1-1/2	23/32	3- 7/8	1/2	4-31/32	4	.39
4853-020	2	27/32	4- 3/4	5/8	5-27/32	4	.50

Tee - Black

SR Fipt x SR Fipt x SR Fipt

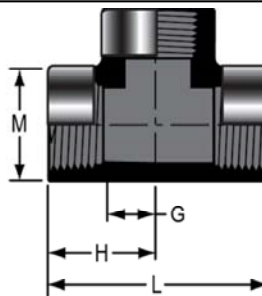

Part Number	Size	G	H	L	M	Approx. Wt. (Lbs.)
4805-005BSR	1/2	19/32	1- 9/32	2-17/32	1- 7/32	.09
4805-007BSR	3/4	21/32	1- 5/16	2-21/32	1- 3/8	.11
4805-010BSR	1	27/32	1-25/32	3- 3/4	1-11/16	.22
4805-015BSR	1-1/2	1- 3/16	2- 1/8	4- 1/4	2- 7/16	.41
4805-020BSR	2	1-19/32	2-19/32	5- 3/16	3	.75

Polypropylene Technical
Polypropylene Schedule 80 Black SR Threaded Fittings



90° EII - Black

SR Fipt x SR Fipt

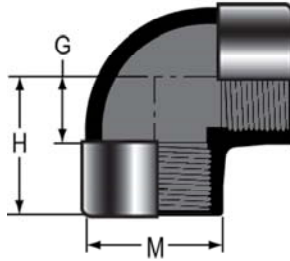

Part Number	Size	G	H	M	Approx. Wt. (Lbs.)
4808-005BSR	1/2	9/16	1- 1/4	1- 7/32	.07
4808-007BSR	3/4	9/16	1- 5/16	1- 3/8	.08
4808-010BSR	1	13/16	1-23/32	1-23/32	.14
4808-015BSR	1-1/2	1- 3/32	2- 3/32	2- 7/16	.31
4808-020BSR	2	1-13/32	2-13/32	3	.52

45° EII - Black

SR Fipt x SR Fipt

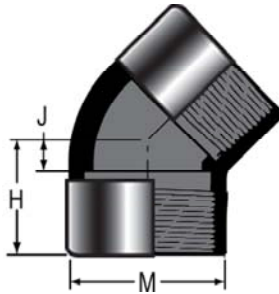

Part Number	Size	H	J	M	Approx. Wt. (Lbs.)
4819-005BSR	1/2	31/32	1/4	1- 7/32	.06
4819-007BSR	3/4	1- 1/16	5/16	1- 3/8	.07
4819-010BSR	1	1- 7/32	5/16	1-23/32	.11
4819-015BSR	1-1/2	1- 3/8	3/8	2-13/32	.23
4819-020BSR	2	1- 5/8	1/2	3- 1/32	.39

Coupling - Black

SR Fipt x SR Fipt

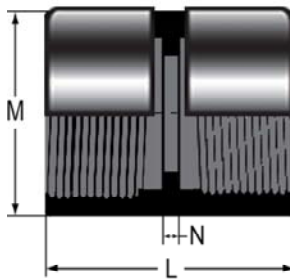

Part Number	Size	L	M	N	Approx. Wt. (Lbs.)
4830-005BSR	1/2	1-19/32	1- 3/16	3/32	.04
4830-007BSR	3/4	1-19/32	1- 3/8	7/32	.05
4830-010BSR	1	2- 1/32	1-23/32	7/32	.09
4830-015BSR	1-1/2	2	2- 7/16	1/8	.17
4830-020BSR	2	2- 3/32	3	3/32	.26



Polypropylene Technical
Polypropylene Schedule 80 Black SR Threaded Fittings

T.T. Bushing - Black

Mipt x Fipt

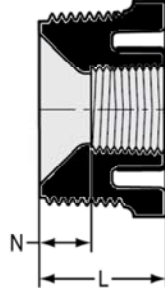

Part Number	Size	L	N	Approx. Wt. (Lbs.)
4839-101B	3/4X1/2	15/16	1/4	.01
4839-130B	1X1/2	1- 1/8	7/16	.03
4839-131B	1X3/4	1- 1/8	7/16	.02
4839-211B	1-1/2X1	1- 7/32	7/16	.05
4839-249B	2X1	1- 5/16	7/16	.10
4839-251B	2X1-1/2	1- 5/16	3/8	.07

Cap - Black

SR Fipt

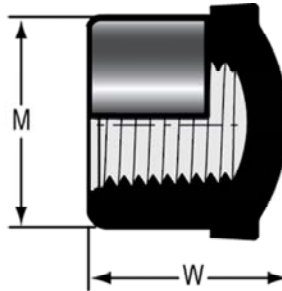

Part Number	Size	M	W	Approx. Wt. (Lbs.)
4848-005BSR	1/2	1- 7/32	1- 3/32	.03
4848-007BSR	3/4	1- 3/8	1- 3/32	.03
4848-010BSR	1	1-23/32	1- 3/8	.06
4848-015BSR	1-1/2	2- 7/16	1-17/32	.14
4848-020BSR	2	3- 1/32	1- 5/8	.21

Union - Black

SR Fipt x SR Fipt with FKM O-ring

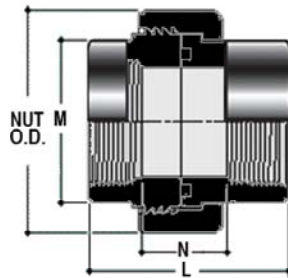

Part Number	Size	L	M	N	NUT O.D.	Approx. Wt. (Lbs.)
4858-005BSR	1/2	1-15/16	1-3/16	15/16	2-1/32	.09
4858-007BSR	3/4	2-5/32	1-3/8	21/32	2-9/32	.13
4858-010BSR	1	2-9/16	1-11/16	13/16	2-9/16	.20
4858-015BSR	1-1/2	2-27/32	2-13/32	29/32	3-17/32	.40
4858-020BSR	2	3-7/32	3-1/32	1-3/16	4-7/32	.63

Polypropylene Technical
Polypropylene Schedule 80 Black SR Threaded Fittings



Union - Black

SR Fipt x SR Fipt with EPDM O-ring

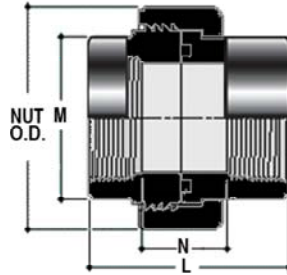

Part Number	Size	L	M	N	NUT O.D.	Approx. Wt. (Lbs.)
4898-005BSR	1/2	1-15/16	1-3/16	15/16	2-1/32	.09
4898-007BSR	3/4	2-5/32	1-3/8	21/32	2-9/32	.13
4898-010BSR	1	2-9/16	1-11/16	13/16	2-9/16	.20
4898-015BSR	1-1/2	2-27/32	2-13/32	29/32	3-17/32	.39
4898-020BSR	2	3-17/32	3-1/32	1-3/16	4-7/32	.63

Flange - Black

SR Fipt

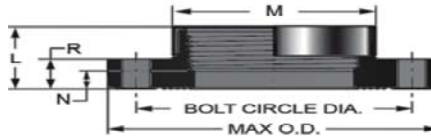

Part Number	Size	L	M	N	R	Bolt Circle Dia.	Bolt Size	Max. O.D.	No of Bolts	Approx. Wt. (Lbs.)
4852-005BSR	1/2	1-3/32	1-7/32	13/32	1/2	2- 3/8	1/2	3-15/32	4	.12
4852-007BSR	3/4	1-3/16	1-3/8	9/32	9/16	2- 3/4	1/2	3-27/32	4	.17
4852-010BSR	1	1-7/16	1-23/32	7/32	5/8	3- 1/8	1/2	4-3/16	4	.24
4852-015BSR	1-1/2	1-11/16	2-7/16	15/32	23/32	3- 7/8	1/2	4-15/32	4	.40
4852-020BSR	2	1-27/32	3	27/32	27/32	4- 3/4	5/8	5-29/32	4	.61

Blind Flange - Black

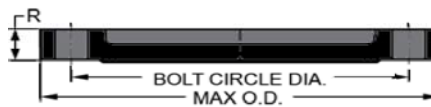

Part Number	Size	R	Bolt Circle Dia.	Bolt Size	Max. O.D.	No of Bolts	Approx. Wt. (Lbs.)
4853-005B	1/2	1/2	2- 3/8	1/2	3-13/32	4	.13
4853-007B	3/4	9/16	2- 3/4	1/2	3-27/32	4	.18
4853-010B	1	5/8	3- 1/8	1/2	4- 3/16	4	.25
4853-015B	1-1/2	23/32	3- 7/8	1/2	4-31/32	4	.29
4853-020B	2	27/32	4- 3/4	5/8	5-27/32	4	.50