



CPVC MARINE PIPE DIMENSIONS

Schedule 40

Nom. Pipe Size (in)	O.D.	Average I.D.	Min. Wall	Nominal Wt./Ft.	Maximum W.P. PSI*
1/2	0.840	0.602	0.109	0.170	600
3/4	1.050	0.804	0.113	0.226	480
1	1.315	1.029	0.133	0.333	450
1-1/4	1.660	1.360	0.140	0.450	370
1-1/2	1.900	1.590	0.145	0.537	330
2	2.375	2.047	0.154	0.720	280
2-1/2	2.875	2.445	0.203	1.136	300
3	3.500	3.042	0.216	1.488	260
4	4.500	3.998	0.237	2.118	220
6	6.625	6.031	0.280	3.733	180
8	8.625	7.942	0.322	5.619	160
10	10.750	9.976	0.365	7.966	140
12	12.750	11.889	0.406	10.534	130

Schedule 80

Nom. Pipe Size (in)	Average O.D.	Average I.D.	Min. Wall	Nominal Wt./Ft.	Maximum W.P. PSI*
1/2	.840	.526	0.147	0.225	850
3/4	1.050	.722	0.154	0.304	690
1	1.315	.936	0.179	0.449	630
1-1/4	1.660	1.255	0.191	0.617	520
1-1/2	1.900	1.476	0.200	0.751	470
2	2.375	1.913	0.218	1.040	400
2-1/2	2.875	2.290	0.276	1.582	420
3	3.500	2.864	0.300	2.121	370
4	4.500	3.786	0.337	3.2101	320
6	6.625	5.709	0.432	6.200	280
8	8.625	7.565	0.500	9.042	250
10	10.750	9.493	0.593	13.018	230
12	12.750	11.294	0.687	18.350	230

ASTM STANDARD DIMENSIONS

CPVC SCHEDULE 80 SOCKET
 DIMENSIONS ASTM F 439

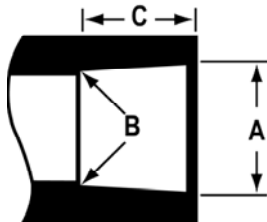

Nominal Size In.	Diameter			Socket Length Minimum C
	Entrance A	Bottom B	Tolerance A	
1/2	.848	.836	± .004	.688
3/4	1.058	1.046	± .004	.719
1	1.325	1.310	± .005	.875
1-1/4	1.670	1.655	± .005	.938
1-1/2	1.912	1.894	± .005	1.094
2	2.387	2.369	± .006	1.156
2-1/2	2.889	2.868	± .006	1.156
3	3.516	3.492	± .007	1.750
4	4.518	4.491	± .008	1.875
6	6.647	6.614	± .010	3.000
8	8.655	8.610	± .011	3.000
10	10.780	10.735	± .015	4.000
12	12.780	12.735	± .015	5.000

ANSI STANDARD DIMENSIONS

AMERICAN NATIONAL STANDARD
 TAPER PIPE THREADS (NPT) ANSI
 B1.20.1, ASTM F 1498

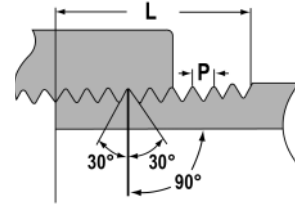

Nominal Size In.	Threads Per Inch.	Effective Thread Length L	Pitch Of Thread P
1/2	14	.5337	.07143
3/4	14	.5457	.07143
1	11-1/2	.6828	.08696
1-1/4	11/12	.7068	.08696
1-1/2	11/12	.7235	.08696
2	11/12	.7565	.08696
2-1/2	8	1.1375	.12500
3	8	1.2000	.12500
4	8	1.3000	.12500
6	8	1.5125	.12500
8	8	1.7125	.12500