

Fabricated Fittings Technical
PVC Low Head PIP Fabricated Fittings, Risers & Accessories



Low Head Cross-Reducer

Socket X Socket X Socket X Socket

(Continued)

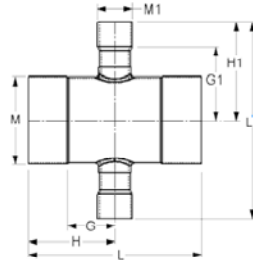

Part Number	Size	G	G1	H	H1	L	L1	M	M1	Approx. Wt. (Lbs.)
280-103303	12X10	7-5/16	9-13/16	12-5/16	14-13/16	24-5/8	29-5/8	12-1/2	10-7/16	10.66
280-103313	15X2	5-9/16	9-3/4	10-9/16	11-1/2	21-1/8	23	15-5/8	2-13/16	9.89
280-103302	12X8	6-9/16	8-13/16	11-9/16	12-13/16	23-1/8	25-5/8	12-1/2	8-5/16	7.88
280-103314	15X3	6-1/16	10-1/2	11-1/16	12-3/4	22-1/8	25-1/2	15-5/8	3-15/16	11.09
280-103315	15X4	6-9/16	10-9/16	11-9/16	12-13/16	23-1/8	25-5/8	15-5/8	4-3/4	11.11
280-103316	15X6	7-7/16	10-3/8	12-7/16	13-3/8	24-7/8	26-3/4	15-5/8	6-1/4	11.92
280-103317	15X8	8-7/16	10-5/16	13-7/16	14-5/16	26-7/8	28-5/8	15-5/8	8-5/8	13.22
280-103318	15X10	9-7/16	11-5/16	14-7/16	16-5/16	28-7/8	32-5/8	15-5/8	10-7/16	16.08
280-103319	15X12	10-7/16	11-5/16	15-7/16	16-5/16	30-7/8	32-5/8	15-5/8	12-1/2	18.51
280-103332	18X2	5-9/16	11-1/4	11-9/16	13	23-1/8	26	18-3/4	2-11/16	15.50
280-103333	18X3	6-3/16	12	12-3/16	14-1/4	24-3/8	28-1/2	18-3/4	3-15/16	13.70
280-103334	18X4	6-11/16	12-1/16	12-11/16	14-5/16	25-3/8	28-5/8	18-3/4	4-3/4	16.49
280-103336	18X8	8-7/16	11-7/8	14-7/16	15-7/8	28-7/8	31-3/4	18-3/4	8-5/16	20.02
280-103337	18X10	9-7/16	12-7/8	15-7/16	17-7/8	30-7/8	35-3/4	18-3/4	10-7/16	20.78
280-103338	18X12	10-7/16	12-7/8	16-7/16	17-7/8	32-7/8	35-3/4	18-3/4	12-7/16	25.55
280-103340	18X15	12-1/16	13-13/16	18-1/16	18-13/16	36-1/8	37-5/8	18-3/4	15-5/8	28.01
280-103343	20X2	6-1/8	12-1/4	12-5/8	14	25-1/4	28	20-13/16	2-11/16	20.75
280-103344	20X3	6-5/8	13	13-1/8	15-1/4	26-1/4	30-1/2	20-1/16	3-15/16	22.30
280-103345	20X4	7-1/8	13-1/16	13-5/8	15-5/16	27-1/4	30-5/8	20-13/16	4-3/4	22.68
280-103346	20X6	8	12-7/8	14-1/2	15-7/8	29	31-3/4	20-13/16	6-1/4	20.30
280-103348	20X10	10	13-7/8	16-1/2	18-7/8	33	37-3/4	20-13/16	10-7/16	29.76
280-103349	20X12	11	13-7/8	17-1/2	17-7/8	35	37-3/4	20-13/16	12-7/16	32.90
280-103351	20X15	12-1/2	14-13/16	19	19-13/16	38	39-5/8	20-13/16	15-5/8	32.37
280-103353	20X18	14	14-13/16	20-1/2	20-13/16	41	41-5/8	20-13/16	18-3/4	38.67
280-103347	20X8	9	12-7/8	15-1/2	16-7/8	31	33-3/4	20-13/16	8-5/16	26.20
280-103335	18X6	7-7/16	11-7/8	13-7/16	14-7/8	26-7/8	29-3/4	18-3/4	6-1/4	18.32

Orchard Riser

Saddle X Riser

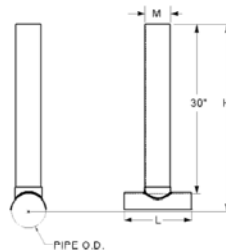

Part Number	Size	H	L	M	Approx. Wt. (Lbs.)
2880-04030	4X4	32-1/2	8-13/16	4-1/2	4.00



Fabricated Fittings Technical
PVC Low Head PIP Fabricated Fittings, Risers & Accessories

Orchard Riser

(Continued)

Saddle X Riser

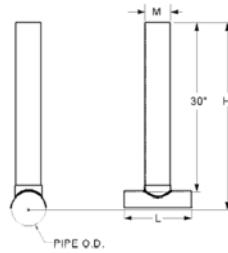

Part Number	Size	H	L	M	Approx. Wt. (Lbs.)
2880-53230	6X4	33-3/16	12	4-1/2	3.30
2880-06030	6X6	33-1/8	13	6-1/8	3.41
2880-58230	8X4	34-3/16	8-3/4	4-1/2	3.12
2880-58530	8X6	34-3/16	10-3/4	6-1/8	3.61
2880-08030	8X8	34-3/16	16	8-3/16	5.28
2880-62430	10X4	35-1/4	8-1/2	4-1/2	3.10
2880-62630	10X6	35-1/4	10-1/2	6-1/8	3.63
2880-62830	10X8	35-1/4	14	8-3/16	5.37
2880-66430	12X4	36-1/4	8-1/2	4-1/2	3.17
2880-66630	12X6	36-1/4	10-1/2	6-1/8	3.65
2880-66830	12X8	36-1/4	13-1/2	8-3/16	5.33
2880-67030	12X10	36-1/4	17	10-3/16	7.64
2880-72430	15X4	37-13/16	8-3/4	4-1/2	3.08
2880-72630	15X6	37-13/16	10-3/4	6-1/8	3.70
2880-72830	15X8	37-13/16	13-3/4		5.11
2880-73030	15X10	37-13/16	16-1/4	10-3/16	7.70
2880-10030	10X10	35-3/16	19	10-3/16	8.48
2880-73230	15X12	37-13/16	19	12-1/4	11.40
2880-78430	18X4	39-5/16	9	4-1/2	3.17
2880-78630	18X6	39-5/16	11	6-1/8	3.59
2880-78830	18X8	39-5/16	13-1/2	8-3/16	5.30
2880-79030	18X10	39-5/16	16-1/2	10-3/16	7.46
2880-15030	15X15	37-13/16	27	15-5/16	20.48
2880-79530	18X15	39-3/8	25	15-5/16	20.41
2880-18030	18X18	39-3/8	32	18-3/8	32.51
2880-81430	20X4	40-3/8	10-3/4	4-1/2	3.59
2880-81630	20X6	40-5/16	10-3/4	6-1/8	3.37
2880-81830	20X8	40-5/16	13-3/4	8-3/16	5.24
2880-12030	12X12	36-1/4	22	12-1/4	12.29
2880-82030	20X10	40-5/16	17	10-3/16	7.62
2880-82230	20X12	40-5/16	19-1/4	12-1/4	12.55
2880-82530	20X15	40-3/8	24-1/2	15-5/16	19.71
2880-82830	20X18	40-7/16	29-1/2	18-3/8	27.53
2880-20030	20X20	40-3/8	38	20-3/8	44.14

Fabricated Fittings Technical
PVC Low Head PIP Fabricated Fittings, Risers & Accessories



Erosion Pot Riser

Saddle X Riser X Pot

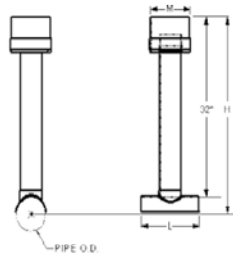

Part Number	Size	H	L	M	Approx. Wt. (Lbs.)
2881-53232	6X4X8	35-3/16	12	8-3/16	5.06
2881-06032	6X6X10	35-1/8	13	10-3/16	5.71
2881-58232	8X4X8	36-3/16	8-3/4	8-3/16	5.00
2881-58532	8X6X10	36-3/16	10-3/4	10-3/16	5.81
2881-08032	8X8X12	36-3/16	16	12-1/4	9.48
2881-62432	10X4X8	37-1/4	8-1/2	8-3/16	4.53
2881-62632	10X6X10	37-1/4	10-1/2	10-3/16	5.92
2881-62832	10X8X12	37-1/4	14	12-1/4	9.01
2881-10032	10X10X15	37-3/16	19	15-5/16	15.30
2881-66432	12X4X8	38-1/4	8-1/2	8-3/16	4.54
2881-66632	12X6X10	38-1/4	10-1/2	10-3/16	6.60
2881-66832	12X8X12	38-1/4	13-1/2	12-1/4	9.03
2881-67032	12X10X15	38-1/4	17	15-5/16	14.45
2881-12032	12X12X18	38-1/4	22	18-3/8	21.46
2881-72432	15X4X8	39-13/16	8-3/4	8-3/16	4.51
2881-72632	15X6X10	39-13/16	10-3/4	10-3/16	6.71
2881-72832	15X8X12	39-13/16	13-3/4	12-1/4	9.22
2881-73032	15X10X15	39-13/16	16-1/4	15-5/16	14.43
2881-73232	15X12X18	39-13/16	19	18-3/8	21.56
2881-15032	15X15X20	39-13/16	27	20-3/8	31.53
2881-78432	18X4X8	41-5/16	9	8-3/16	4.59
2881-78632	18X6X10	41-5/16	11	10-3/16	6.05
2881-78832	18X8X12	41-5/16	13-1/2	12-1/4	8.52
2881-79032	18X10X15	41-5/16	16-1/2	15-5/16	14.34
2881-79232	18X12X18	41-3/8	19	18-3/8	20.96
2881-79532	18X15X20	41-3/8	25	20-3/8	29.79
2881-81432	20X4X8	42-3/8	10-3/4	8-3/16	5.14
2881-81632	20X6X10	42-5/16	10-3/4	10-3/16	5.98
2881-81832	20X8X12	42-5/16	13-3/4	12-1/4	9.05
2881-82032	20X10X15	42-5/16	17	15-5/16	14.23
2881-82232	20X12X18	42-3/8	19-1/4	18-3/8	21.11
2881-82532	20X15X20	42-3/8	24-1/2	20-3/8	29.50



Fabricated Fittings Technical
PVC Low Head PIP Fabricated Fittings, Risers & Accessories

Mechanical Vent Assembly

Saddle X Riser/Vent

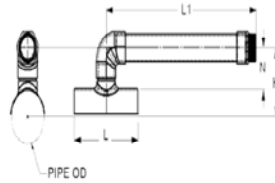

Part Number	Size	H	L	L1	N	Approx. Wt. (Lbs.)
2882-420	4X2	5-13/16	8-3/4	20-5/8	3-9/16	2.24
2882-422	4X3	7-1/8	8	21-3/4	4-7/8	4.57
2882-528	6X2	6-5/8	8-3/4	20-5/8	3-9/16	2.29
2882-530	6X3	7-15/16	9	21-3/4	4-7/8	4.79
2882-532	6X4	8-3/4	12	22-7/16	5-11/16	5.15
2882-578	8X2	7-11/16	8-1/2	20-5/8	3-9/16	2.26
2882-580	8X3	8-15/16	8-1/2	21-3/4	4-7/8	4.73
2882-582	8X4	9-3/4	8-3/4	22-7/16	5-11/16	4.96
2882-621	10X2	8-11/16	8-1/2	20-5/8	3-9/16	2.29
2882-623	10X3	10	8-3/4	21-3/4	4-7/8	4.61
2882-624	10X4	10-13/16	8-1/2	22-7/16	5-11/16	4.89
2882-661	12X2	9-11/16	8-3/4	20-5/8	3-9/16	2.30
2882-663	12X3	11	8-1/2	21-3/4	4-7/8	4.63
2882-664	12X4	11-13/16	8-1/2	22-7/16	5-11/16	4.91
2882-721	15X2	11-1/4	8-3/4	20-5/8	3-9/16	2.36
2882-723	15X3	12-1/2	8-3/4	21-3/4	4-7/8	4.61
2882-724	15X4	13-5/16	8-3/4	22-7/16	5-11/16	5.17
2882-781	18X2	12-3/4	9	20-5/8	3-9/16	2.38
2882-783	18X3	14-1/16	9	21-3/4	4-7/8	4.94
2882-784	18X4	14-7/8	9	22-7/16	5-11/16	5.03
2882-811	20X2	13-3/4	9	20-5/8	3-9/16	2.40
2882-813	20X3	15-1/16	9	21-3/4	4-7/8	4.85
2882-814	20X4	15-7/8	10-3/4	22-7/16	5-11/16	5.71



Low Head PIP Mechanical Vent Riser

Saddle x Riser/Vent x Chamber

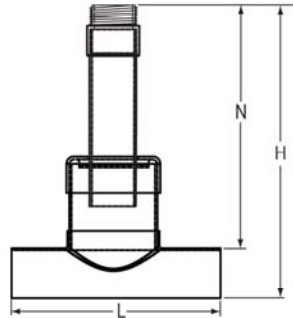

Part Number	Size	H	L	N	Approx. Wt. (Lbs.)
2883-52842	6X2X4	45-3/16	12	42	3.92
2883-57842	8X2X6	46-3/16	10-3/4	42	4.38
2883-58042	8X3X6	46-3/16	10-3/4	42	7.06
2883-62142	10X2X8	47-1/4	14	42	5.30
2883-62342	10X3X8	47-1/4	14	42	8.32
2883-62442	10X4X8	47-1/4	14	42	6.74
2883-66142	12X2X10	48-1/4	17	42	7.84
2883-66342	12X3X10	48-1/4	17	42	9.95
2883-66442	12X4X10	48-1/4	17	42	9.11
2883-72442	15X4X12	49-15/16	26	42	12.97
2883-78442	18X4X15	51-3/8	25	42	20.87
2883-81442	20X4X18	52-7/16	29-1/2	42	28.62

Low Head PIP Vent Base

Saddle x Riser x Outlet

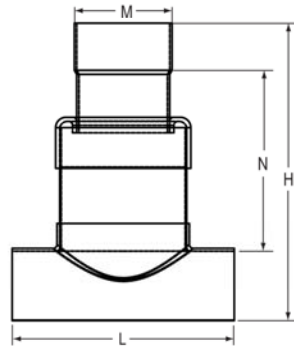

Part Number	Size	H	L	M	N	Approx. Wt. (Lbs.)
2888-532020	6X4X2	10-11/16	12	2-11/16	5-7/8	1.70
2888-585030	8X6X3	14-13/16	10-3/4	3-15/16	8-1/2	2.44
2888-585040	8X6X4	15-1/8	10-3/4	4-3/4	8-13/16	2.35
2888-628060	10X8X6	18-5/16	14	6-1/4	10-13/16	3.35
2888-670060	12X10X6	21-1/8	17	6-1/4	12	5.87
2888-732080	15X12X8	25-7/16	19	8-5/16	13-13/16	9.97
2888-795080	18X15X8	30	25	8-5/16	16-13/16	17.62



Fabricated Fittings Technical
PVC Low Head PIP Fabricated Fittings, Risers & Accessories

Low Head PIP Vent Base

(Continued)

Saddle x Riser x Outlet

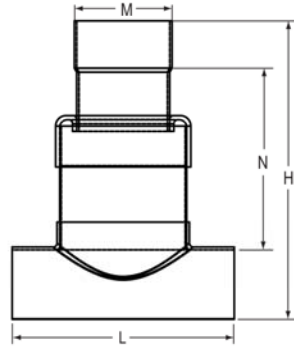

Part Number	Size	H	L	M	N	Approx. Wt. (Lbs.)
2888-828080	20X18X8	34-1/8	29-1/2	8-5/16	19-15/16	28.19

Low Head PIP Wye

Socket x Socket x Socket

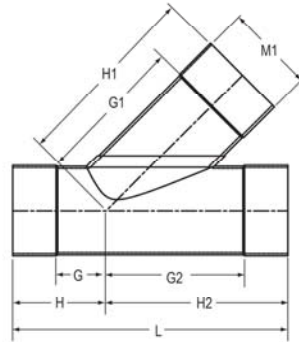

Part Number	Size	G	G1	G2	H	H1	H2	L	M	M1	Approx. Wt. (Lbs.)
2875-060	6	3-11/16	10-15/16	9-13/16	6-11/16	13-15/16	12-13/16	19-1/2	6-1/4	6-1/4	2.42
2875-080	8	4-5/8	13-13/16	12-3/4	8-5/8	17-13/16	16-3/4	25-3/8	8-5/16	8-5/16	4.95
2875-100	10	5-11/16	16-3/4	15-15/16	10-11/16	21-3/4	20-15/16	31-5/8	10-7/16	10-7/16	8.75
2875-120	12	6-11/16	19-1/8	18-15/16	11-11/16	24-1/8	23-15/16	35-5/8	12-1/2	12-1/2	14.00
2875-150	15	8-7/16	23-9/16	23-11/16	13-7/16	28-9/16	28-11/16	42-1/8	15-5/8	15-5/8	25.44
2875-183	18	7-3/16	25-9/16	25-9/16	13-3/16	31-9/16	31-9/16	44-3/4	18-3/4	18-3/4	39.97
2875-200	20	9-5/8	30	30	16-1/8	36-1/2	36-1/2	52-5/8	20-13/16	20-13/16	55.48