

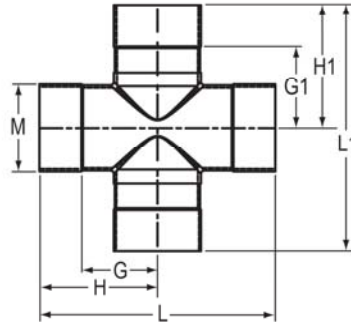

Fabricated Fittings Technical
PVC Low Head PIP Fabricated Fittings, Risers & Accessories

Low Head PIP Cross

Socket x Socket x Socket x Socket



Part Number	Size	G	G1	H	H1	L	L1	M	Approx. Wt. (Lbs.)
280-103286	6	5-1/2	5-7/8	8-1/2	8-7/8	17	17-3/4	6-1/4	2.24
280-103291	8	6-9/16	6-13/16	10-9/16	10-13/16	21-1/8	21-5/8	8-5/16	4.07
280-103297	10	7-9/16	8-13/16	12-9/16	13-13/16	25-1/8	27-5/8	10-7/16	8.32
280-103304	12	8-11/16	9-13/16	13-11/16	14-13/16	27-3/8	29-5/8	12-1/2	12.33
280-103321	15	11-15/16	12-5/16	16-15/16	17-5/16	33-7/8	34-5/8	15-5/8	20.79
280-103342	18	13-9/16	13-13/16	19-9/16	19-13/16	39-1/8	39-5/8	18-3/4	34.36
280-103354	20	15	15-13/16	21-1/2	21-13/16	43	43-5/8	20-13/16	52.87

Low Head Cross-Reducer

Socket X Socket X Socket X Socket

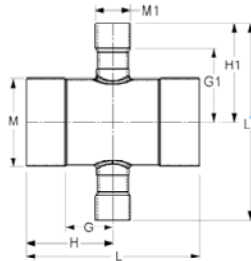

Part Number	Size	G	G1	H	H1	L	L1	M	M1	Approx. Wt. (Lbs.)
280-103283	6X2	3-5/8	5-1/4	6-5/8	7	13-1/4	14	6-1/4	2-11/16	1.55
280-103284	6X3	4-1/4	6	7-1/4	8-1/4	14-1/2	16-1/2	6-1/4	3-15/16	2.40
280-103285	6X4	4-3/4	6-1/16	7-3/4	8-5/16	15-1/2	16-5/8	6-1/4	4-3/4	2.07
280-103287	8X2	3-11/16	6-1/4	7-11/16	8	15-3/8	16	8-5/16	2-11/16	2.05
280-103288	8X3	4-3/16	7	8-3/16	9-1/4	16-3/8	18-1/2	8-5/16	3-15/16	3.12
280-103289	8X4	4-11/16	7-1/16	8-11/16	9-5/16	17-3/8	18-5/8	8-5/16	4-3/4	3.06
280-103290	8X6	5-9/16	6-7/8	9-9/16	9-7/8	19-1/8	19-3/4	8-5/16	6-1/4	3.41
280-103292	10X2	3-11/16	7-1/4	8-11/16	9	17-3/8	18	10-7/16	2-11/16	3.87
280-103293	10X3	4-3/16	8	9-3/16	10-1/4	18-3/18	20-1/2	10-7/16	3-15/16	4.82
280-103294	10X4	4-11/16	8-1/16	9-11/16	10-5/16	19-3/8	20-5/8	10-7/16	4-3/4	4.61
280-103295	10X6	5-9/16	7-7/8	10-9/16	10-7/8	21-1/8	21-3/4	10-7/16	6-1/4	4.95
280-103296	10X8	6-9/16	7-13/16	11-9/16	11-13/16	23-1/8	23-5/8	10-7/16	8-5/16	5.58
280-103298	12X2	3-11/16	8-1/4	8-11/16	10	17-3/8	20	12-1/2	2-11/16	5.45
280-103299	12X3	4-5/16	9	9-5/16	11-1/4	18-5/8	22-1/2	12-1/2	3-15/16	6.50
280-103300	12X4	4-13/16	9-1/16	9-13/16	11-5/16	19-5/8	22-5/8	12-1/2	4-3/4	6.27
280-103301	12X6	5-9/16	8-7/8	10-9/16	11-7/8	21-1/8	23-3/4	12-1/2	6-1/4	6.88

Fabricated Fittings Technical
PVC Low Head PIP Fabricated Fittings, Risers & Accessories



Low Head Cross-Reducer

Socket X Socket X Socket X Socket

(Continued)

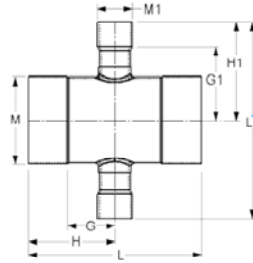

Part Number	Size	G	G1	H	H1	L	L1	M	M1	Approx. Wt. (Lbs.)
280-103303	12X10	7-5/16	9-13/16	12-5/16	14-13/16	24-5/8	29-5/8	12-1/2	10-7/16	10.66
280-103313	15X2	5-9/16	9-3/4	10-9/16	11-1/2	21-1/8	23	15-5/8	2-13/16	9.89
280-103302	12X8	6-9/16	8-13/16	11-9/16	12-13/16	23-1/8	25-5/8	12-1/2	8-5/16	7.88
280-103314	15X3	6-1/16	10-1/2	11-1/16	12-3/4	22-1/8	25-1/2	15-5/8	3-15/16	11.09
280-103315	15X4	6-9/16	10-9/16	11-9/16	12-13/16	23-1/8	25-5/8	15-5/8	4-3/4	11.11
280-103316	15X6	7-7/16	10-3/8	12-7/16	13-3/8	24-7/8	26-3/4	15-5/8	6-1/4	11.92
280-103317	15X8	8-7/16	10-5/16	13-7/16	14-5/16	26-7/8	28-5/8	15-5/8	8-5/8	13.22
280-103318	15X10	9-7/16	11-5/16	14-7/16	16-5/16	28-7/8	32-5/8	15-5/8	10-7/16	16.08
280-103319	15X12	10-7/16	11-5/16	15-7/16	16-5/16	30-7/8	32-5/8	15-5/8	12-1/2	18.51
280-103332	18X2	5-9/16	11-1/4	11-9/16	13	23-1/8	26	18-3/4	2-11/16	15.50
280-103333	18X3	6-3/16	12	12-3/16	14-1/4	24-3/8	28-1/2	18-3/4	3-15/16	13.70
280-103334	18X4	6-11/16	12-1/16	12-11/16	14-5/16	25-3/8	28-5/8	18-3/4	4-3/4	16.49
280-103336	18X8	8-7/16	11-7/8	14-7/16	15-7/8	28-7/8	31-3/4	18-3/4	8-5/16	20.02
280-103337	18X10	9-7/16	12-7/8	15-7/16	17-7/8	30-7/8	35-3/4	18-3/4	10-7/16	20.78
280-103338	18X12	10-7/16	12-7/8	16-7/16	17-7/8	32-7/8	35-3/4	18-3/4	12-7/16	25.55
280-103340	18X15	12-1/16	13-13/16	18-1/16	18-13/16	36-1/8	37-5/8	18-3/4	15-5/8	28.01
280-103343	20X2	6-1/8	12-1/4	12-5/8	14	25-1/4	28	20-13/16	2-11/16	20.75
280-103344	20X3	6-5/8	13	13-1/8	15-1/4	26-1/4	30-1/2	20-1/16	3-15/16	22.30
280-103345	20X4	7-1/8	13-1/16	13-5/8	15-5/16	27-1/4	30-5/8	20-13/16	4-3/4	22.68
280-103346	20X6	8	12-7/8	14-1/2	15-7/8	29	31-3/4	20-13/16	6-1/4	20.30
280-103348	20X10	10	13-7/8	16-1/2	18-7/8	33	37-3/4	20-13/16	10-7/16	29.76
280-103349	20X12	11	13-7/8	17-1/2	17-7/8	35	37-3/4	20-13/16	12-7/16	32.90
280-103351	20X15	12-1/2	14-13/16	19	19-13/16	38	39-5/8	20-13/16	15-5/8	32.37
280-103353	20X18	14	14-13/16	20-1/2	20-13/16	41	41-5/8	20-13/16	18-3/4	38.67
280-103347	20X8	9	12-7/8	15-1/2	16-7/8	31	33-3/4	20-13/16	8-5/16	26.20
280-103335	18X6	7-7/16	11-7/8	13-7/16	14-7/8	26-7/8	29-3/4	18-3/4	6-1/4	18.32

Orchard Riser

Saddle X Riser

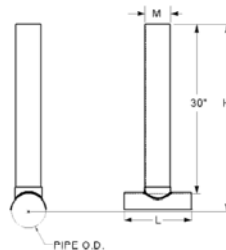

Part Number	Size	H	L	M	Approx. Wt. (Lbs.)
2880-04030	4X4	32-1/2	8-13/16	4-1/2	4.00