

Fabricated Fittings Technical
CPVC Schedule 80 DWV Fabricated Fittings



90° Street Ell SCH 80

(Continued)

Socket X Socket

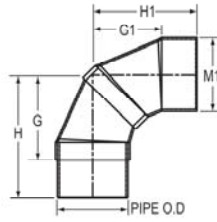

Part Number	Size	G	G1	H	H1	M	Approx. Wt. (Lbs.)
3909-030C	3	4-1/16	3-3/4	6-3/32	5-5/8	4-3/16	2.50
3909-040C	4	4-31/32	4-19/32	7-13/32	6-7/8	5-1/4	4.39
3909-060C	6	9	7-1/2	13	10-3/4	7-1/2	12.51
3909-080C	8	11-1/4	9-1/4	16-1/4	13-1/2	9-5/8	24.13
3909-100C	10	14-5/16	11-13/16	20-5/16	17-1/16	11-15/16	42.52
3909-120C	12	16-5/8	13-5/8	23-5/8	19-7/8	14-1/8	74.92
3909-140C	14	19-1/2	16	27-1/2	23	15-1/2	112.42
3909-160C	16	22-7/16	18-7/16	31-7/16	26-7/16	17-11/16	164.40
3909-180C	18	25-3/8	20-7/8	35-3/8	29-7/8	19-7/8	200.00
3909-200C	20	28-5/16	23-5/16	39-1/16	33-5/16	22-1/16	294.00
3909-240C	24	34-1/4	28-1/4	47-1/4	40-1/4	26-7/16	546.72

11-1/4° Elbow SCH 80

Socket X Socket

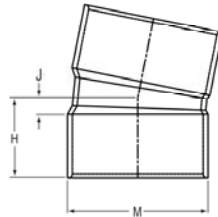

Part Number	Size	H	J	M	Approx. Wt. (Lbs.)
3911-040C	4	3	3/4	5-3/16	1.80
3911-060C	6	4-1/4	1	7-1/2	4.68
3911-080C	8	5-3/8	1-1/8	9-5/8	8.72
3911-100C	10	6-11/16	1-7/16	11-15/16	15.81
3911-120C	12	7-13/16	1-9/16	14-1/8	29.05
3911-140C	14	9	2	15-1/2	35.90
3911-160C	16	10-3/8	2-3/8	17-11/16	55.59
3911-180C	18	11-3/4	2-3/4	19-7/8	83.44
3911-200C	20	13-1/8	3-1/8	22-1/16	99.90
3911-240C	24	15-13/16	3-13/16	26-7/16	196.95



Fabricated Fittings Technical
CPVC Schedule 80 DWV Fabricated Fittings

15° Elbow SCH 80

Socket X Socket

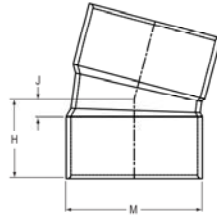

Part Number	Size	H	J	M	Approx. Wt. (Lbs.)
3918-040C	4	3-1/8	7/8	5-3/16	1.79
3918-060C	6	4-3/8	1-1/8	7-1/2	4.77
3918-080C	8	5-1/2	1-1/4	9-5/8	8.81
3918-100C	10	6-15/16	1-11/16	11-15/16	17.29
3918-120C	12	8-1/16	1-13/16	14-1/8	27.73
3918-140C	14	9-5/16	2-5/16	15-1/2	40.74
3918-160C	16	10-11/16	2-11/16	17-11/16	59.47
3918-180C	18	12-1/16	3-1/16	19-7/8	83.44
3918-200C	20	13-1/2	3-1/2	22-1/16	99.90
3918-240C	24	16-1/4	4-1/4	26-7/16	202.28

22-1/2° Elbow SCH 80

Socket X Socket

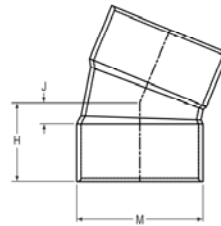

Part Number	Size	H	J	M	Approx. Wt. (Lbs.)
3916-040C	4	3-1/4	1	5-3/16	1.85
3916-060C	6	4-5/8	1-3/8	7-1/2	5.16
3916-080C	8	5-7/8	1-5/8	9-5/8	9.36
3916-100C	10	7-5/16	2-1/16	11-15/16	17.59
3916-120C	12	8-9/16	2-5/16	14-1/8	29.69
3916-140C	14	9-13/16	2-13/16	15-1/2	37.75
3916-160C	16	11-5/16	3-5/16	17-11/16	57.95
3916-180C	18	12-3/4	3-3/4	19-7/8	86.42
3916-200C	20	14-1/4	4-1/4	22-1/16	103.22
3916-240C	24	17-3/16	5-3/16	26-7/16	205.70

Fabricated Fittings Technical
CPVC Schedule 80 DWV Fabricated Fittings



22-1/2° Street Elbow SCH 80

Socket X Socket

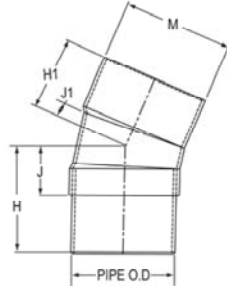

Part Number	Size	H	H1	J	J1	M	Approx. Wt. (Lbs.)
3942-060C	6	6-5/8	3-5/16	2-5/8	1/16	7-1/2	5.28
3942-080C	8	8-11/16	3-9/16	3-11/16	11/16	9-5/8	6.56
3942-100C	10	11-5/8	4-5/8	4-5/8	5/8	11-15/16	17.90
3942-120C	12	11-15/16	5-3/4	4-15/16	1/2	14-1/8	29.05
3942-140C	14	14-1/16	6-5/16	6-1/16	11/16	15-1/2	41.51
3942-160C	16	17-1/4	5-15/16	8-1/4	2-1/16	17-11/16	52.97
3942-180C	18	18-1/4	12-3/4	8-1/4	3-3/4	19-7/8	74.44
3942-200C	20	20-1/4	14-1/4	9-1/4	4-1/4	22-1/16	157.38
3942-240C	24	24-3/16	17-3/16	11-3/16	5-3/16	26-7/16	266.16

30° Elbow SCH 80

Socket X Socket

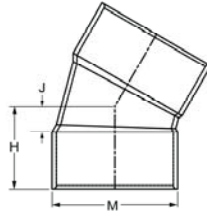

Part Number	Size	H	J	M	Approx. Wt. (Lbs.)
3915-040C	4	3-7/16	1-3/16	5-3/16	2.15
3915-060C	6	4-7/8	1-5/8	7-1/2	5.42
3915-080C	8	6-3/16	1-15/16	9-5/8	10.04
3915-100C	10	7-3/4	2-1/2	11-15/16	17.68
3915-120C	12	9-1/16	2-13/16	14-1/8	30.39
3915-140C	14	10-7/16	3-7/16	15-1/2	42.92
3916-160C	16	11-5/16	3-5/16	17-11/16	57.95
3915-180C	18	13-1/2	4-1/2	19-7/8	92.38
3915-200C	20	15	5	22-1/16	109.88
3915-240C	24	18-1/8	6-1/8	26-7/16	185.25



Fabricated Fittings Technical
CPVC Schedule 80 DWV Fabricated Fittings

45° Elbow SCH 80

Socket X Socket

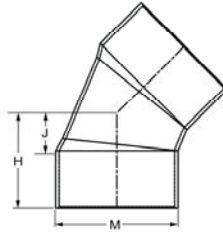

Part Number	Size	H	J	M	Approx. Wt. (Lbs.)
3917-020C	2	2-3/4	1	2-13/16	.52
3917-030C	3	3-5/8	1-3/8	4-1/8	1.38
3917-040C	4	3-7/8	1-5/8	5-3/16	2.04
3917-060C	6	5-1/2	2-1/4	7-1/2	5.44
3917-080C	8	6-15/16	2-11/16	9-5/8	11.43
3917-100C	10	8-11/16	3-7/16	11-15/16	19.37
3917-120C	12	10-1/8	3-7/8	14-1/8	32.40
3917-140C	14	11-9/16	4-9/16	15-1/2	41.37
3917-160C	16	13-5/16	5-5/16	17-11/16	64.66
3917-180C	18	15	6	19-7/8	88.48
3917-200C	20	16-3/4	6-3/4	22-1/16	124.66
3917-240C	24	20-3/16	8-3/16	26-7/16	207.66

45° Street Elbow SCH 80

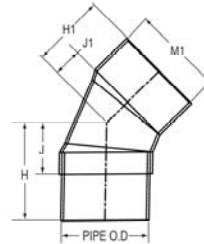

Part Number	Size	H	H1	J	J1	M	Approx. Wt. (Lbs.)
3927-015C	1-1/2	2-13/16	1-13/16	1-3/16	7/16	2-3/8	.48
3927-020C	2	3-1/8	2-1/8	1-3/8	5/8	2-7/8	.66
3927-030C	3	4-1/8	2-7/8	1-7/8	7/8	4	1.65
3927-040C	4	4-11/16	3-5/16	2-3/16	1-1/16	5-1/4	3.03
3927-060C	6	7-3/4	5-1/2	3-3/4	2-1/4	7-1/2	7.42
3927-080C	8	9-11/16	6-15/16	4-11/16	2-11/16	9-5/8	13.87
3927-100C	10	11-15/16	8-11/16	5-15/16	3-7/16	11-15/16	26.25
3927-120C	12	13-7/8	10-1/8	6-7/8	3-7/8	14-1/8	45.87
3927-140C	14	16-1/16	11-9/16	8-1/16	4-9/16	15-1/2	64.42
3927-160C	16	18-5/16	13-5/16	9-5/16	5-5/16	17-11/16	90.40
3927-180C	18	20-1/2	15	10-1/2	6	19-7/8	131.11
3927-200C	20	22-3/4	16-3/4	11-3/4	6-3/4	22-1/16	153.18
3927-240C	24	27-3/16	20-3/16	14-3/16	8-3/16	26-7/16	123.29

Fabricated Fittings Technical
CPVC Schedule 80 DWV Fabricated Fittings



60° Elbow SCH 80

Socket X Socket

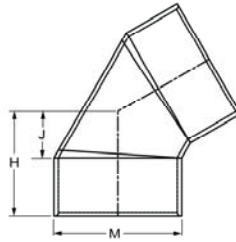

Part Number	Size	H	J	M	Approx. Wt. (Lbs.)
3924-040C	4	4-5/16	2-1/16	5-3/16	2.31
3924-060C	6	6-1/8	2-7/8	7-1/2	5.92
3924-080C	8	7-3/4	3-1/2	9-5/8	10.94
3924-100C	10	9-11/16	4-7/16	11-15/16	21.91
3924-120C	12	11-5/16	5-1/16	14-1/8	31.43
3924-140C	14	12-15/16	5-15/16	15-1/2	88.89
3924-160C	16	14-13/16	6-13/16	17-11/16	126.08
3924-180C	18	16-3/4	7-3/4	19-7/8	175.81
3924-200C	20	26-5/8	16-5/8	22-1/16	247.63
3924-240C	24	32-1/8	20-1/8	26-7/16	415.20

Coupling

Socket X Socket

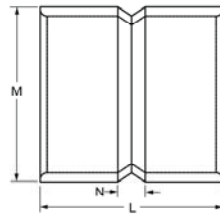

Part Number	Size	L	M	N	Approx. Wt. (Lbs.)
3929-020C	2	4-3/4	2-13/16	1-1/4	.46
3929-030C	3	5-3/4	4-1/8	1-1/4	1.18
3929-040C	4	6-1/2	5-3/16	2	1.91
3929-060C	6	8-1/2	7-1/2	2	4.71
3929-080C	8	10-3/8	9-5/8	1-7/8	8.70
3929-100C	10	13-1/8	11-15/16	2-5/8	15.68
3929-120C	12	15-1/4	14-1/8	2-3/4	25.85
3929-140C	14	16	15-1/2	2	33.33
3929-160C	16	19-3/4	17-11/16	3-3/4	54.79
3929-180C	18	22	19-7/8	4	72.88
3929-200C	20	25-3/4	22-1/16	5-3/4	102.09
3929-240C	24	29-1/4	26-7/16	5-1/4	167.66