

Fabricated Fittings Technical
PVC Schedule 40 & 80 DWV Fabricated Fittings



Double Combo Wye- SCH 40- Reducing

(Continued)

Socket X Socket X Socket X Socket

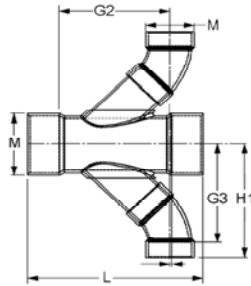

Part Number	Size	G1	G2	G3	H1	L	M	M1	Approx. Wt. (Lbs.)
3792-624	10X4	1-1/16	12-9/16	13-1/4	15-1/16	24-1/8	11-1/2	5-1/16	21.14
3792-626	10X6	1-9/16	16-3/16	14-11/16	17-11/16	28-1/4	11-1/2	7-1/4	29.38
3792-628	10X8	3/4	20- 1/4	17-1/8	21-3/16	31-1/2	11-1/2	9-3/8	44.69
3792-661	12X2	1-13/16	8-11/16	11-1/4	12	23	13-9/16	2-3/4	20.00
3792-663	12X3	1-3/8	10-5/8	12-11/16	14-1/4	24-1/2	13-9/16	4	24.00
3792-664	12X4	1-1/16	12-7/16	14-1/4	16	26	13-9/16	5-1/16	27.51
3792-666	12X6	1-1/2	16	15-5/8	18-11/16	30	13-9/16	7-1/4	36.56
3792-668	12X8	9/16	19-15/16	18- 1/8	22-1/8	33	13-9/16	9-3/8	50.74
3792-670	12X10	1/16	23-9/16	20-3/4	25-7/8	36	13-9/16	12-1/16	88.32
3792-691	14X2	1-5/8	8-3/8	11-13/16	12-5/8	24	14-7/8	2-3/4	27.01
3792-693	14X3	1-11/16	10-13/16	13-5/16	14-13/16	26-1/2	14-7/8	4	32.05
3792-694	14X4	1-5/16	12-11/16	14-13/16	16-5/8	28	14-7/8	5-1/16	35.25
3792-696	14X6	1-1/4	15-3/4	16-1/4	19-1/4	31	14-7/8	7-1/4	44.79
3792-698	14X8	5/16	19-11/16	18-11/16	22-3/4	34	14-7/8	9-3/8	60.31
3792-700	14X10	1/4	23-1/4	21-3/8	27-7/16	37	14-7/8	12-1/16	95.64
3792-702	14X12	1/8	28-1/8	24-1/4	30-5/16	42	14-7/8	14-1/4	137.91

Sanitary Tee SCH 40

Socket x Socket x Socket

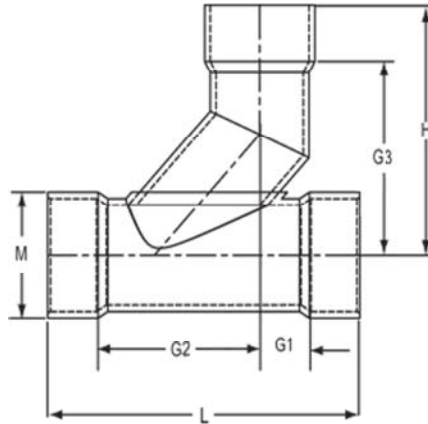

Part Number	Size	G1	G2	G3	H	L	M	Approx. Wt. (Lbs.)
3790-060	6	4-3/16	12-3/16	11-15/16	15-3/16	22-7/8	7-3/16	10.41
3790-080	8	4-5/8	15-5/16	15-3/16	19-7/16	28-7/16	9-1/4	21.24
3790-100	10	6-9/16	17-1/4	19-1/8	24-3/8	34-5/16	11-1/2	37.03
3790-120	12	5-5/8	21-3/4	21-13/16	28-1/16	39-7/8	13-9/16	58.37
3790-140	14	5-5/16	23-1/16	22-3/4	29-3/4	42-3/8	14-7/8	71.47
3790-160	16	6-5/8	26-7/8	25-1/2	33-1/2	49-1/2	17	105.59
3790-180	18	7-1/16	29-13/16	28-1/16	37-1/16	54-7/8	19-1/8	151.87



Fabricated Fittings Technical
PVC Schedule 40 & 80 DWV Fabricated Fittings

Sanitary Tee SCH 40

Socket x Socket x Socket

(Continued)

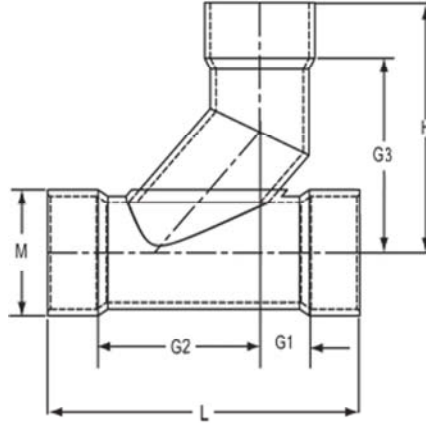

Part Number	Size	G1	G2	G3	H	L	M	Approx. Wt. (Lbs.)
3790-200	20	7-9/16	34-3/16	32-1/16	42-1/16	61-3/4	21-3/16	202.78
3790-240	24	7-11/16	38-5/16	37-13/16	49-13/16	70	25-3/8	320.99

Sanitary Tee SCH 40- Reducer

Socket X Socket X Socket

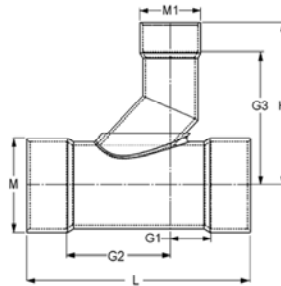

Part Number	Size	G1	G2	G3	H	L	M	M1	Approx. Wt. (Lbs.)
3790-528	6X2	2-3/4	5-5/8	7-3/8	8-1/8	14-7/8	7-3/16	2-3/4	4.93
3790-530	6X3	3- 1/4	7	9-11/16	11-15/16	16-3/4	7-3/16	3-15/16	6.74
3790-532	6X4	3-5/16	8-7/16	10-3/16	12-7/16	18-1/4	7-3/16	5	8.01
3790-578	8X2	3-1/2	6-1/4	8-3/8	9-1/8	18-1/4	9-1/4	2-3/4	9.11
3790-580	8X3	3- 3/4	7- 1/2	10- 5/8	12-7/8	19-3/4	9-1/4	3-15/16	10.13
3790-582	8X4	3- 7/8	8- 7/8	11- 1/8	13-3/8	21-1/4	9-1/4	5	12.07
3790-585	8X6	3- 7/8	11- 3/4	12- 7/8	16-1/8	24-1/8	9-1/4	7-3/16	15.48
3790-621	10X2	3-1/2	6-1/4	9-3/8	10-1/8	20-1/4	11-1/2	2-3/4	12.97
3790-623	10X3	4- 1/16	7-11/16	11- 5/8	13-7/8	22-1/4	11-1/2	3-15/16	15.85
3790-624	10X4	4- 5/16	9- 5/16	12- 1/8	14-3/8	24-1/8	11-1/2	5	17.73
3790-626	10X6	4-15/16	12-13/16	13- 7/8	17-1/8	28-1/4	11-1/2	7-3/16	22.99
3790-628	10X8	5- 1/4	15- 3/4	16- 3/16	20-7/16	31-1/2	11-1/2	9-1/4	28.96
3790-661	12X2	3-15/16	6-9/16	10-5/16	11-1/16	23	13-9/16	2-3/4	20.37
3790-663	12X3	4- 1/4	7- 3/4	12- 5/8	14-7/8	24-1/2	13-9/16	3-15/16	22.86
3790-664	12X4	4- 5/16	9- 3/16	13- 1/8	15-3/8	26	13-9/16	5	24.22
3790-666	12X6	4- 7/8	12- 5/8	14- 7/8	18-1/8	30	13-9/16	7-3/16	29.62
3790-668	12X8	5	15- 1/2	17- 1/8	21-3/8	33	13-9/16	9-1/4	35.66
3790-670	12X10	5- 1/16	18- 7/16	20- 1/16	25-5/16	36	13-9/16	11-1/2	46.53
3790-691	14X2	3-11/16	6-5/16	10-15/16	11-11/16	24	14-7/8	2-3/4	26.44
3790-693	14X3	4- 1/2	8	13- 3/16	15-7/16	26-1/2	14-7/8	3-15/16	26.71
3790-694	14X4	4- 9/16	9- 7/16	13-11/16	15-15/16	28	14-7/8	5	33.02

Fabricated Fittings Technical
PVC Schedule 40 & 80 DWV Fabricated Fittings



Sanitary Tee SCH 40- Reducer

Socket X Socket X Socket

(Continued)

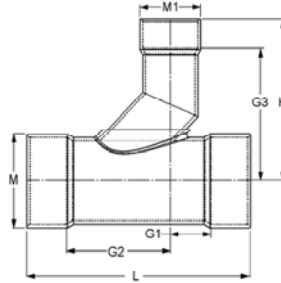

Part Number	Size	G1	G2	G3	H	L	M	M1	Approx. Wt. (Lbs.)
3790-696	14X6	4- 5/8	12- 3/8	15- 7/16	18-11/16	31	14-7/8	7-3/16	35.24
3790-698	14X8	4-13/16	15- 3/16	17- 3/4	22	34	14-7/8	9-1/4	46.81
3790-700	14X10	4- 7/8	18- 1/8	20-11/16	25-15/16	37	14-7/8	11-1/2	53.19
3790-702	14X12	6	22	22- 3/8	28-5/8	42	14-7/8	13-9/16	62.84
3790-751	16X2	4-3/4	7-1/4	11-7/8	12-5/8	28	17	2-3/4	39.87
3790-753	16X3	5-3/16	8-9/16	14-1/8	16-3/8	29-3/4	17	3-15/16	42.01
3790-754	16X4	5-1/8	9-7/8	14-5/8	16-7/8	31	17	5	44.68
3790-756	16X6	6-1/16	13-11/16	16-3/8	19-5/8	35-3/4	17	7-3/16	52.18
3790-758	16X8	5-3/8	15-5/8	18-11/16	22-15/16	37	17	9-1/4	56.71
3790-760	16X10	5-7/16	18-9/16	21-5/8	26-7/8	40	17	11-1/2	69.27
3790-762	16X12	5- 9/16	21- 7/16	23- 5/16	29-9/16	43	17	13-9/16	79.29
3790-764	16X14	5-9/16	23-3/16	23-11/16	30-11/16	44-3/4	17	14-7/8	91.51
3790-784	18X4	5-9/16	10-3/16	15-9/16	17-13/16	33-3/4	19-1/8	5	62.08
3790-786	18X6	6-1/8	13-5/8	17-5/16	20-9/16	37-3/4	19-1/8	7-3/16	71.16
3790-788	18X8	6-5/16	16-7/16	19-5/8	23-7/8	40-3/4	19-1/8	9-1/4	77.53
3790-790	18X10	5-7/8	18-7/8	22-9/16	27-13/16	42-3/4	19-1/8	11-1/2	87.62
3790-792	18X12	6	21-3/4	24-1/4	30-1/2	45-3/4	19-1/8	13-9/16	98.45
3790-794	18X14	5-5/8	23-1/8	24-5/8	31-5/8	46-3/4	19-1/8	14-7/8	106.01
3790-796	18X16	6-13/16	26-15/16	26-7/16	34-7/16	51-3/4	19-1/8	17	132.94
3790-814	20X4	6-1/8	10-5/8	16-9/16	18-3/16	36-3/4	21-3/16	5	76.68
3790-816	20X6	6-3/16	13-9/16	18-5/16	21-9/16	39-3/4	21-3/16	7-3/16	84.61
3790-818	20X8	6-5/16	16-7/16	20-9/16	24-13/16	42-3/4	21-3/16	9-1/4	98.09
3790-820	20X10	5-7/8	18-7/8	23-1/2	28-3/4	44-3/4	21-3/16	11-1/2	106.97
3790-822	20X12	6- 1/2	22- 1/4	25- 1/4	31-1/2	48-3/4	21-3/16	13-9/16	123.14
3790-824	20X14	6-3/16	23-9/16	25-9/16	32-9/16	49-3/4	21-3/16	14-7/8	131.45
3790-826	20X16	6-3/8	26-3/8	27-3/8	35-3/8	52-3/4	21-3/16	17	156.28
3790-828	20X18	6-9/16	29-3/16	29-1/16	38-1/16	55-3/4	21-3/16	19-1/8	174.23
3790-904	24X4	6-15/16	11-5/16	18-7/16	20-11/16	42-1/4	25-3/8	5	122.56
3790-906	24X6	7-1/8	14-3/8	20-3/16	23-7/16	45-1/2	25-3/8	7-3/16	129.51
3790-908	24X8	7-5/16	17-3/16	22-1/2	26-3/4	48-1/2	25-3/8	9-1/4	141.07
3790-910	24X10	7	19-3/4	25-7/16	30-11/16	50-3/4	25-3/8	11-1/2	160.89
3790-912	24X12	7- 1/2	23	27- 1/8	33-3/8	54-1/2	25-3/8	13-9/16	180.79
3790-914	24X14	7-3/8	24-5/8	27-1/2	34-1/2	56	25-3/8	14-7/8	191.72
3790-916	24X16	8-7/16	28-5/16	29-5/16	37-5/16	60-3/4	25-3/8	17	215.88
3790-918	24X18	8-5/8	31-1/18	30-15/16	39-15/16	63-3/4	25-3/8	19-1/8	245.12
3790-920	24X20	8-1/2	33-3/4	33-15/16	43-15/16	66-1/4	25-3/8	21-3/16	267.47



Fabricated Fittings Technical
PVC Schedule 40 & 80 DWV Fabricated Fittings

Double Sanitary Tee SCH 40

Socket X Socket X Socket X Socket

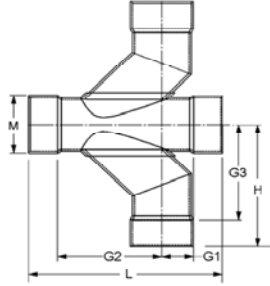

Part Number	Size	G1	G2	G3	H	L	M	Approx. Wt. (Lbs.)
3791-060	6	4- 3/16	12- 3/16	11-15/16	15-3/16	22-7/8	7-3/16	16.79
3791-080	8	4- 5/8	15- 5/16	15-3/16	19-7/16	28-7/16	9-1/4	29.95
3791-100	10	5- 3/16	18- 5/8	19-1/8	24-3/8	34-5/16	11-1/2	56.60
3791-120	12	5- 5/8	21- 3/4	21-13/16	28-1/16	39-7/8	13-9/16	77.02
3791-140	14	5- 5/16	23- 1/16	22-3/4	29-3/4	42-3/8	14-7/8	103.85

Double Sanitary Tee SCH 40-Reducer

Socket X Socket X Socket X Socket

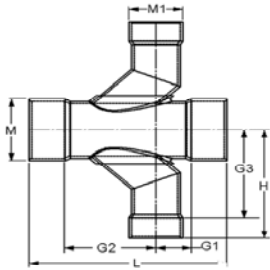

Part Number	Size	G1	G2	G3	H	L	M	M1	Approx. Wt. (Lbs.)
3791-528	6X2	2-3/4	5-5/8	7-3/8	8-1/8	14-7/8	7-3/16	2-3/4	5.28
3791-530	6X3	3- 1/4	7	9-11/16	11-15/16	16-3/4	7-3/16	3-15/16	7.81
3791-532	6X4	3- 5/16	8- 7/16	10- 3/16	12-7/16	18-1/4	7-3/16	5	8.98
3791-578	8X2	3-1/2	6-1/4	8-3/8	9-1/8	18-1/4	9-1/4	2-3/4	9.47
3791-580	8X3	3- 3/4	7- 1/2	10- 5/8	12-7/8	19-3/4	9-1/4	3-15/16	11.89
3791-582	8X4	3- 7/8	8- 7/8	11- 1/8	13-3/8	21-1/4	9-1/4	5	13.72
3791-585	8X6	3- 7/8	11- 3/4	12- 7/8	16-1/8	24-1/8	9-1/4	7-3/16	20.45
3791-621	10X2	3-1/2	6-1/4	9-3/8	10-1/8	20-1/4	11-1/2	2-3/4	12.97
3791-623	10X3	4- 1/16	7-11/16	11- 5/8	13-7/8	22-1/4	11-1/2	3-15/16	16.94
3791-624	10X4	4- 5/16	9- 5/16	12- 1/8	14-3/8	24-1/8	11-1/2	5	19.69
3791-626	10X6	4-15/16	12-13/16	13- 7/8	17-1/8	28-1/4	11-1/2	7-3/16	26.98
3791-628	10X8	5- 1/4	15- 3/4	16- 3/16	20-7/16	31-1/2	11-1/2	9-1/4	34.86
3791-661	12X2	3-15/16	6-9/16	10-5/16	11-1/16	23	13-9/16	2-3/4	20.70
3791-663	12X3	4- 1/4	7- 3/4	12- 5/8	14-7/8	24-1/2	13-9/16	3-15/16	24.05
3791-664	12X4	4- 5/16	9- 3/16	13- 1/8	15-3/8	26	13-9/16	5	25.77
3791-666	12X6	4- 7/8	12- 5/8	14- 7/8	18-1/8	30	13-9/16	7-3/16	37.00
3791-668	12X8	5	15- 1/2	17- 1/8	21-3/8	33	13-9/16	9-1/4	44.61
3791-670	12X10	5- 1/16	18- 7/16	20- 1/16	25-5/16	36	13-9/16	11-1/2	59.55
3791-691	14X2	3-11/16	6-5/16	10-15/16	11-11/16	24	14-7/8	2-3/4	26.86
3791-693	14X3	4- 1/2	8	13-3/16	15-7/16	26-1/2	14-7/8	3-15/16	31.58
3791-694	14X4	4- 9/16	9- 7/16	13-11/16	15-15/16	28	14-7/8	5	33.85
3791-696	14X6	4- 5/8	12- 3/8	15-7/16	18-11/16	31	14-7/8	7-3/16	41.24

Fabricated Fittings Technical
PVC Schedule 40 & 80 DWV Fabricated Fittings



Double Sanitary Tee SCH 40-Reducer

(Continued)

Socket X Socket X Socket X Socket

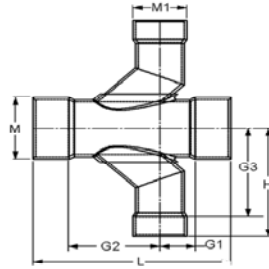

Part Number	Size	G1	G2	G3	H	L	M	M1	Approx. Wt. (Lbs.)
3791-698	14X8	4-13/16	15- 3/16	17- 3/4	22	34	14-7/8	9-1/4	55.20
3791-700	14X10	4- 7/8	18- 1/8	20-11/16	25-15/16	37	14-7/8	11-1/2	68.97
3791-702	14X12	6	22	22- 3/8	28-5/8	42	14-7/8	13-9/16	83.48

Sanitary Tee SCH 80

Socket x Socket x Socket

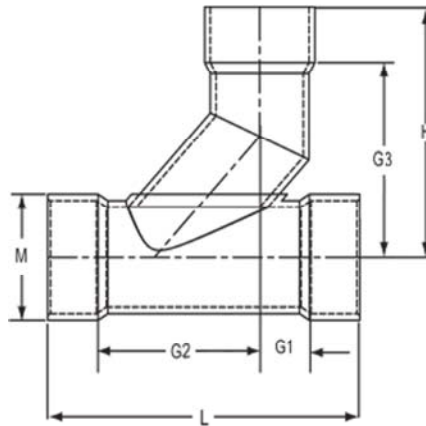

Part Number	Size	G1	G2	G3	H	L	M	Approx. Wt. (Lbs.)
3990-020	2	3-15/16	6-1/4	5-3/4	7-1/4	13-1/4	2-7/8	2.22
3990-030	3	4-7/8	8-3/8	8-5/16	10-3/16	17	4-3/16	5.45
3990-040	4	4-9/16	9-5/16	10-1/16	12-5/16	18-3/8	5-3/16	7.22
3990-060	6	4-5/8	11-7/8	12-1/16	15-5/16	23	7-1/2	16.96
3990-080	8	4-1/2	14-1/4	14-7/8	19-1/8	27-1/4	9-5/8	31.45
3990-100	10	5-11/16	18-1/16	17-13/16	23-1/16	34-1/4	11-15/16	59.66
3990-120	12	6-1/8	20-7/8	20-9/16	26-13/16	39-1/2	14-1/8	93.56
3990-140	14	8-3/4	24-7/8	22-5/16	29-5/16	47-5/8	15-1/2	127.04
3990-160	16	8-13/16	27-3/8	25-1/16	33-1/16	52-1/4	17-11/16	107.79
3990-180	18	8-9/16	29-7/16	27-13/16	36-13/16	56	19-7/8	259.96
3990-200	20	10	33-1/4	30-9/16	40-9/16	63-1/4	22-1/16	355.73
3990-240	24	12-1/4	40-1/4	36-9/16	48-9/16	76-1/2	26-7/16	684.24



Fabricated Fittings Technical
PVC Schedule 40 & 80 DWV Fabricated Fittings

Sanitary Tee SCH 80- Reducer

Socket X Socket X Socket

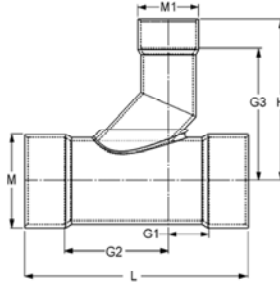

Part Number	Size	G1	G2	G3	H	L	M	M1	Approx. Wt. (Lbs.)
3990-528	6X2	3-15/16	6-9/16	7-11/16	9-3/16	17	7-1/2	2-7/8	9.21
3990-530	6X3	4-3/16	8-5/16	9	11-1/4	19	7-1/2	4-1/8	11.31
3990-532	6X4	5	9-1/2	11	13-1/4	21	7-1/2	5-3/16	12.52
3990-578	8X2	3-15/16	6-7/16	8-5/8	10-1/8	18-7/8	9-5/8	2-7/8	10.87
3990-580	8X3	4-1/4	8-1/4	9-15/16	12-3/16	21	9-5/8	4-1/8	15.41
3990-582	8X4	5-1/16	9-7/16	11-15/16	14-3/16	23	9-5/8	5-3/16	18.67
3990-585	8X6	5-11/16	12-13/16	13	16-1/4	27	9-5/8	7-1/2	25.19
3990-621	10X2	4	6-1/4	9-9/16	11-1/8	20-3/4	11-15/16	2-7/8	23.43
3990-623	10X3	4-1/4	8	10-7/8	13-1/8	22-3/4	11-15/16	4-1/8	16.38
3990-624	10X4	5	9-1/4	12-15/16	15-3/16	24-3/4	11-15/16	5-3/16	29.82
3990-626	10X6	5-5/8	12-5/8	14	17-1/4	28-3/4	11-15/16	7-1/2	38.19
3990-628	10X8	5-13/16	15-7/16	15-13/16	20-1/16	31-3/4	11-15/16	9-5/8	47.44
3990-661	12X2	4	6-1/8	10-1/2	12	22-5/8	14-1/8	2-7/8	35.57
3990-663	12X3	4-11/16	8-5/16	11-13/16	14-1/16	25-1/2	14-1/8	4-1/8	40.90
3990-664	12X4	5	9	13-13/16	16-1/16	26-1/2	14-1/8	5-3/16	43.63
3990-666	12X6	5-5/8	12-3/8	14-7/8	18-1/8	30-1/2	14-1/8	7-1/4	49.42
3990-668	12X8	5-15/16	15-5/16	16-3/4	21	33-3/4	14-1/8	9-5/8	64.19
3990-670	12X10	6-1/16	18-3/16	18-11/16	23-15/16	36-3/4	14-1/8	11-15/16	77.67
3990-691	14X2	5-3/4	7-3/4	11-1/16	12-9/16	27-1/2	15-1/2	2-7/8	48.65
3990-693	14X3	5-3/4	9-1/4	12-3/8	14-5/8	29	15-1/2	4-1/8	52.94
3990-694	14X4	6-5/16	10-3/16	14-3/8	16-5/8	30-1/2	15-1/2	5-3/16	55.87
3990-696	14X6	5-11/16	12-5/16	15-7/16	18-11/16	32	15-1/2	7-1/2	63.10
3990-698	14X8	6-5/8	15-7/8	17-5/16	21-9/16	36-1/2	15-1/2	9-5/8	76.18
3990-700	14X10	6-3/4	18-3/4	19-1/4	24-1/2	39-1/2	15-1/2	11-15/16	90.27
3990-702	14X12	6-7/8	21-5/8	21-3/16	27-7/16	42-1/2	15-1/2	14-1/8	110.25
3990-751	16X2	6-1/4	8	11-15/16	13-1/2	30-1/4	17-11/16	2-7/8	68.64
3990-753	16X3	6-1/4	9-1/2	13-1/4	15-1/2	31-3/4	17-11/16	4-1/8	73.87
3990-754	16X4	7-1/4	11	15-5/16	17-9/16	34-1/4	17-11/16	5-3/16	79.40
3990-756	16X6	6-3/8	12-7/8	16-3/8	19-5/8	35-1/4	17-11/16	7-1/4	85.45
3990-758	16X8	7-1/16	16-3/16	18-3/16	22-7/16	39-1/4	17-11/16	9-5/8	100.41
3990-760	16X10	7-3/16	19-1/16	20-3/16	25-7/16	42-1/4	17-11/16	11-15/16	115.91
3990-762	16X12	7-5/16	21-11/16	22-1/16	28-5/16	45	17-11/16	14-1/8	137.30
3990-764	16X14	7-7/8	23-7/8	23-3/16	30-3/16	47-3/4	17-11/16	15-1/2	152.20
3990-784	18X4	7-1/4	10-3/4	16-3/16	18-7/16	36	19-7/8	5-3/16	109.30
3990-786	18X6	6-5/16	21-5/8	17-3/8	20-5/8	36-15/16	19-7/8	7-1/4	116.02
3990-788	18X8	7-9/16	25-7/16	19-1/8	23-3/8	42	19-7/8	9-5/8	136.48
3990-790	18X10	7-11/16	19-5/16	21-1/16	26-5/16	45	19-7/8	11-15/16	154.01
3990-792	18X12	7-7/8	22-1/8	22-15/16	29-3/16	48	19-7/8	14-1/8	177.42
3990-794	18X14	8-1/8	23-7/8	24-1/8	31-1/8	50	19-7/8	15-1/2	191.55

Fabricated Fittings Technical
PVC Schedule 40 & 80 DWV Fabricated Fittings



Sanitary Tee SCH 80- Reducer

(Continued)

Socket X Socket X Socket

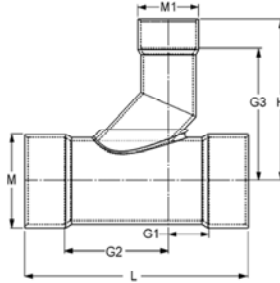

Part Number	Size	G1	G2	G3	H	L	M	M1	Approx. Wt. (Lbs.)
3990-796	18X16	8-5/16	26-11/16	25-15/16	33-15/16	53	19-7/8	17-11/16	221.58
3990-814	20X4	7-5/16	10-11/16	17-1/8	19-3/8	38	22-1/16	5-3/16	143.31
3990-816	20X6	6-13/16	12-15/16	18-3/16	21-7/16	39-3/4	22-1/16	7-1/2	150.67
3990-818	20X8	8-1/4	17	20	24-1/4	45-1/4	22-1/16	9-5/8	177.67
3990-820	20X10	8-3/8	19-7/8	22	27-1/4	48-1/4	22-1/16	11-15/16	198.10
3990-822	20X12	8-5/8	22-5/8	23-13/16	30-1/16	51-1/4	22-1/16	14-1/8	222.37
3990-824	20X14	9-5/16	24-15/16	25	32	54-1/4	22-1/16	15-1/2	241.16
3990-826	20X16	9-7/16	27-9/16	26-7/8	34-7/8	57	22-1/16	17-11/16	273.07
3990-828	20X18	9-3/4	30-1/2	28-3/4	37-3/4	60-1/4	22-1/16	18-3/4	313.32
3990-904	24X4	7-1/2	10-1/2	18-15/16	21-3/16	42	26-7/16	5-3/16	221.45
3990-906	24X6	8-1/4	13-15/16	20	23-1/4	46-1/4	26-7/16	7-1/2	244.79
3990-908	24X8	9-9/16	17-15/16	21-13/16	26-1/16	51-1/2	26-7/16	9-5/8	280.39
3990-910	24X10	9-11/16	20-13/16	23-13/16	29-1/16	54-1/2	26-7/16	11-15/16	304.09
3990-912	24X12	9-15/16	23-9/16	25-11/16	31-15/16	57-1/2	26-7/16	14-1/8	333.68
3990-914	24X14	10-5/8	25-7/8	26-13/16	33-13/16	60-1/2	26-7/16	15-1/2	356.77
3990-916	24X16	10-7/8	28-5/8	28-11/16	36-11/16	63-1/2	26-7/16	17-11/16	392.97
3990-918	24X18	11-1/16	31-7/16	30-9/16	39-9/16	66-1/2	26-7/16	19-7/8	437.52
3990-920	24X20	10-3/16	33-1/16	32-3/8	42-3/8	67-1/4	26-7/16	22-1/16	473.09

IPS X Sewer Adapter SCH 40

IPS Socket x Sewer Spigot

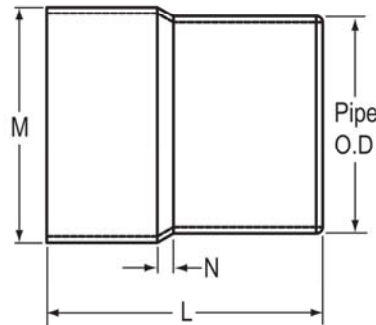

Part Number	Size	L	M	N	Approx. Wt. (Lbs.)
3729-04013IXS	4	6-1/8	4-3/4	7/16	.52
3729-06013IXS	6	8-1/4	7	1	1.71
3729-08013IXS	8	10-5/8	9-1/8	5/8	3.67
3729-10013IXS	10	12-1/2	11-3/8	1-1/4	7.15
3729-12013IXS	12	14-1/2	13-1/2	1-1/4	11.66